

Final Program



4-6 June 2012

Organized by



Sponsored by



Contents



General Information	4
Badges.....	4
Best Paper Award.....	6
Conference Location	4
Conference Proceedings	5
Internet Connection	5
Meeting Room	5
Need Help?	5
Paper Legend	6
Registration.....	4
Social Event and Lunches	5
Tickets.....	5
Quick Program Overview.....	7
Welcome Address.....	10
Keynote.....	10
Scientific Program	10
Monday, June 4.....	10
Tuesday, June 5.....	14
Wednesday, June 6	17
ISC'2013	19
Conference Locations.....	20
Notes.....	23
Registration Form	24

General Information

1.1 Conference Location

The Conference itself is held at



The [Faculty of Information Technology](#)
 BUT, Božetěchova 2,
 612 66 Brno, Czech Republic
 Tel.: +420 54114 1144
 Fax: +420 54114 1270
 Email: info@fit.vutbr.cz

The meeting room is **room A113**. The registration desk will be placed near the meeting room. Registration will start on Monday at 8.30 a.m. till 5.00 p.m. On Tuesday it will be from 8.30 a.m. - 5.00 p.m. with Wednesday registration only from 9.00 a.m.- 09.30. a.m. The faculty itself is located in Kralovo Pole, location of the Cartesian monastery. The location can be reached by tram and bus.

ALL MAPS ARE AT THE BACK OF THIS PROGRAMME

1.2 Badges

Each registrant will receive a name badge upon registration. The badge must be worn in order to be admitted to the technical sessions, lunches and social event.

1.3 Tickets

Extra tickets for the social event and lunches are available from the Registration desk. (**at conference prices**)

Price: (or equivalent in another currency) for extra tickets. All participants will be issued with tickets for lunch and the conference dinner. **Or just the badge will apply.**

conference dinner:	€ 45
lunch	€ 25

1.4 Registration

The **ISC'2012** Registration Desk will be open for information and registration:

Monday, June 48.30 a.m. to 5.00 p. m.
Tuesday, June 58.30 a.m. to 5.00 p. m.
Wednesday, June 6.....9.00 a.m. to 9.30 a.m.

General Information

1.5 Conference Proceedings

Each fully paid registrant will be provided with a copy of the Conference Proceedings (printed format). (Extra copies are available on a **cash and carry** basis at special rates during ISC-2012)

Price: (or equivalent in another currency) for an extra copy

ISC'2012 Proceedings	€ 50
Other Proceedings –see price list at desk	

Other Proceedings can be ordered using the forms available at the conference.

1.6 Meeting Room

The meeting room is room A113. Directions to the room will be signposted.

1.7 Internet Connection

There is full free WIFI at the conference site.

1.9 Need Help?

Please see the conference desk for your questions

1.10 Social Events and Lunches

All registrants are invited:

To the **Coffee Breaks** and **lunches** for the 2 ½ days which will be served at the Faculty of Information Technology.

To the **Conference Dinner**



The conference dinner will be held on the 5th of June in the evening at the

[U Královny Elišky](#)

Mendlovo náměstí 1b

603 00 Brno

Tel: +420 543 212 578

Email: info@ukralovnyelisky.cz

We will meet at the entrance of the restaurant at 19.30 p.m

General Information

1.12 Best Paper Award

During the conference the papers, which were accepted as extended papers will be judged by the committee and participants in order to choose the best paper of the ISC'2012 conference. The best paper candidate receives a certificate signed by the General Conference and Program Chairs and also a free registration to any EUROSIS conference within 2 years of receipt of the prize.

1.13 Paper Legend:

Each paper is designated before each paper by its number. This number has to be entered on the form for the best paper award

The room has an LCD projector and an overhead projector

SESSION CHAIRPERSONS:

ALL SESSION CHAIRPERSONS IN THIS PROGRAM ARE PROVISIONAL. **Session Chairs** are chosen on a voluntary basis by proposals by either authors or local committee members or are appointed by the Track Chairs, General Program Chair or General Conference Chair. They are responsible for their assigned session. They make sure their speakers are available, take care of the timing within the session, chair the discussion after each presentation and introduce each speaker based on the CV's given to them by the authors. **If a session chair is not available then the first author takes on the responsibility to chair**

Sessions with extended papers:

If you are a session chair in a session with extended papers make sure the session participants have a copy of the best paper award form and ask them to return them to you at the end of the session. After the session hand over the collected forms to Philippe Geril

THE NUMBERS NEXT TO THE PRESENTATIONS DENOTE THE PAGE-NUMBERS IN THE PROCEEDINGS. IF NO NUMBERS ARE MENTIONED THEN THIS PAPER IS NOT PUBLISHED IN THE PROCEEDINGS

THE AUTHORS WHO ARE UNDERLINED ARE NORMALLY THE PRESENTERS

ONLY PAPERS IN GREY BOXES ARE THE EXTENDED PAPERS ELIGIBLE FOR THE BEST PAPER AWARD

MONDAY, 4th JUNE 2012	
08.30-17.00	REGISTRATION
09.00-09.15	OPENING SESSION I
09.15-10.00	KEYNOTE ADDRESS BY MARTIN HRUBY –MEETING ROOM A113
10.00-10.30	COFFEE BREAK
10.30-12.30	SESSION II
	MEETING ROOM A113
	SOFTWARE DESIGN SIMULATION
12.30-13.30	LUNCH BREAK
13.30-15.00	SESSION III
	MEETING ROOM A113
	MANUFACTURING ROBOT CONTROL SIMULATION
15.00-15.30	COFFEE BREAK
15.30-18.30	SESSION IV
	MEETING ROOM A113
	PROJECT MANAGEMENT SIMULATION
FREE EVENING	

TUESDAY, 5th JUNE 2012

08.30-17.00	REGISTRATION
09.00-10.00	SESSION V
09.00-10.00	INVITED SPEECH CLEMENS HEITZINGER –ROOM A113
10.00-10.30	COFFEE BREAK
10.30-12.30	SESSION VI
	MEETING ROOM A113
	ELECTRONICS SIMULATION
12.30-13.30	LUNCH BREAK
13.30-15.00	SESSION VII
	MEETING ROOM A113
	SIMULATION IN TRANSPORT AND LOGISTICS
15.00-15.30	COFFEE BREAK
15.30-18.00	SESSION VIII
	MEETING ROOM A113
	IN-HOUSE AND PRODUCTION LOGISTICS
19.30 – 22.00	CONFERENCE DINNER.

WEDNESDAY, 6th JUNE 2012	
09.00-09.30	REGISTRATION
09.00 10.00	SESSION IX
	MEETING ROOM A113
	SUPPLY CHAIN SIMULATION
10.00-10.30	COFFEE BREAK
10.30 13.00	SESSION X
	MEETING ROOM A113
	SIMULATION IN ENGINEERING
13.00-13.15	CLOSING SESSION XI AND BEST PAPER AWARD – ROOM A113

Monday, 4th June 2012

HALLWAY

Registration

08.30 - 17.00

MEETING ROOM

09.00 – 09.15

KEYNOTE

Opening ISC2012 and Welcome

Welcome Address

Doc. Ing. Vladimír Janoušek, Brno University of Technology, Brno, Czech Republic
ISC'2012, General Conference Chair

Ing. Šárka Květoňová, Brno University of Technology, Brno, Czech Republic
ISC'2012, General Program Chair

09.15 – 10.00

MEETING ROOM- 09.15-10.00

KEY

KEYNOTE SPEECH

Chair: Vladimír Janoušek, Brno University of Technology, Brno, Czech Republic

Modeling the Electricity Markets in Central Europe

Dr. Martin Hruby, FIT, Brno University of Technology (BUT), Brno, Czech Republic

Monday, 4th June 2012

10.00 - 10.30
COFFEE BREAK

10.30 – 12.30

MEETING ROOM- 10.30-12.30 **DESIGN**
SOFTWARE DESIGN SIMULATION
Chair: Radek Koci, Brno Univ. of Technology, Brno, Czech Republic

METH_04
Sharing Limited Resources in Software Process Simulations
Štěpán Kuchař, David Ježek, Jan Kožusznik and Svatopluk Štolfa..... 33

VERIF_01
Generic Source Code Migration Using Decompilation
Lukas Durfina, Jakub Kroustek and Petr Zemek 38

METH_06
System Dynamic Simulation Engine on Java platform
Luboš Chupáč, Jan Korpas, Jan Kožusznik, Svatopluk Štolfa
and Oldřich Vašut 43

MIL_01
Matlab Tool Support for Safety Analysis of High Consequence Arming System Designs
Dan Slipper, Alistair A. McEwan, Wilson Ifill, Gordon Hunter,
Roger Green and Richard Johnson 49

12.30 - 13.30
LUNCH BREAK

13.30 – 15.00

ROOM A- 13.30-15.00 **MANUF**
MANUFACTURING ROBOT CONTROL SIMULATION
Chair: Radek Koci, Brno Univ. of Technology, Brno, Czech Republic

<p>MANUF_01 Optimizing Blended PTP Movements for Industrial Robots by Means of Metaheuristics Juergen Rossmann, <u>Sven Severin</u> and Oliver Stern..... 187</p>

Monday, 4th June 2012

MANUF_08 An Adaptive Harmony Search Algorithm to solve a Robotic Assembly Line Balancing Problem Slim Daoud, Farouk Yalaoui, Lionel Amodeo, Hicham Chehade and Philippe Duperray	193
--	------------

MANUF_02 A New Formulation of a Buffered Two Workstation Production Line with Parallel Unreliable Machines Yassine Ouazene, Alice Yalaoui, Hicham Chehade and Farouk Yalaoui	200
--	------------

15.00 - 15.30
COFFEE BREAK

15.30 - 18.30

ROOM- 15.30-18.30 **MGMT**
PROJECT MANAGEMENT SIMULATION
Chair: Vladimír Janoušek, Brno University of Technology, Brno, Czech Republic, Brno Univ. of Technology, Brno, Czech Republic

ENERG_01 Industry Project Evaluation with the Analytic Hierarchy Process Sebastian Zimmer, Matthias Klumpp and Hella Abidi	10
--	-----------

METH_08 Modelling of Project Portfolio in Renew based on Object Oriented Petri Nets (OOPN) Michal Němec and Šárka Květoňová.....	5
--	----------

METH_05_AI Generic Model for University Course Timetabling Problem solved by Genetic Algorithm Maqsood Ahmad, Christophe Caux and Michel Gourgand	209
---	------------

METH_09 Model Based Decision Support System for Communal Water Works Marcin Stachura, Bartłomiej Fajdek and Jan Studzinski	19
--	-----------

Monday, 4th June 2012

CHEM_02

Evolution Modeling Algorithm of Biochemical Networks

Tatjana Rubina and Egils Stalidzans 24

ENERG_02

Experience with Full 3D Nuclear Reactor Model

Janos Sebestyen Janosy and Jozsef Pales..... 63

FREE EVENING

Sessions - Monday

Tuesday, 5th June 2012

HALLWAY

Registration

08.30 - 17.00

09.00 – 10.00

MEETING ROOM- 09.00-10.00

INV

INVITED SPEECH

Chair: Vladimír Janoušek, Brno University of Technology, Brno, Czech Republic

Mathematical modeling, simulation, and rational design of nanowire sensors

Dr Clemens Heitzinger, DAMTP, Centre for Mathematical Sciences, University of Cambridge, Cambridge, United Kingdom

10.00 - 10.30

COFFEE BREAK

10.30 - 12.30

MEETING ROOM - 10.30-12.30

ELEC

ELECTRONICS SIMULATION

Chair: Vladimír Janoušek, Brno University of Technology, Brno, Czech Republic

ELEC_01

Verification of Initialization Sequences for Sequential Circuits by using Dependency Matrixes

Kestutis Morkunas and Rimantas Seinauskas..... 71

MANUF_10_ELEC

Usage of Simulators in Testing System

Ludek Dolihal, Tomas Hruska and Karel Masarik..... 74

ANA_01

Simulation of Aesthetic Rating of CAD Layouts

Daniel Skiera, Mark Hoenig, Juergen Hoetzel, Pawel Dabrowski and

Slawomir Nikiel 79

Tuesday, 5th June 2012

DESIGN_02

Thermal Impulse Sensor with Four Points Acquisition Card for Temperature Measurement

Vlad Jinga, Cornel Samoilă, Doru Ursuțiu and Petrică Cotfas 85

12.30 - 13.30

LUNCH BREAK

13.30 - 15.00

MEETING ROOM- 13.30-15.00

LOGIS

SIMULATION IN TRANSPORT AND LOGISTICS

Chair: Václav Simek, Brno Univ. of Technology, Brno, Czech Republic

TRANS_09_TRAF

Design of a Hybrid Nanoscopic/Microscopic Road Traffic Simulation

Tomas Potuzak..... 122

TRANS_01

A Multi Start Iterated Local Search algorithm for the multi compartment vehicle routing problem

Cadet David Joseph, Christian Prins, Lionel Amodeo and Farouk Yalaoui 125

TRANS_08

Simulation Approach for an Integrated Decision Support System for Demand Responsive Transport Planning and Operation

Ana Dias, José Telhada and Maria Sameiro Carvalho 130

15.00 - 15.30

COFFEE BREAK

15.30 – 18.00

ROOM A- 15.30-18.00

LOGIS

IN-HOUSE AND PRODUCTION LOGISTICS

Chair: Dusan Kolár, Brno Univ. of Technology, Brno, Czech Republic

TRANS_02

Modeling Individual Decision Makers In A Multi Agent Warehouse Simulation

Christoph Schwarz and Axel Hahn 153

Sessions - Tuesday

Tuesday, 5th June 2012

TRANS_04_LOGIS

Simulation in the Design of an Internal Logistic System – Milk Run Delivering with Kanban Control

Luís S. Dias, Pavel Vik, José A. Oliveira and Guilherme Pereira 159

MANUF_05

Evaluating Replenishment Systems under Perturbed Environments

S. T. Enns and Chandandeep S. Grewal..... 169

MANUF_11

The Redesign of the Process Control of Concrete Systems Ltd. PTY for a more Effective and Efficient Production Process

M.P.W. van der Velden, H.P.M. Veeke and G. Lodewijks 174

MANUF_06

An Improved Largest GAP Routing Heuristic for Order Picking

Jinping Liu, Veronique Limère and Hendrik Van Landeghem..... 179

CONFERENCE DINNER – 19.30-22.00



The conference dinner will be held on the 5th of June in the evening at the [U Královny Elišky](#)

Mendlovo náměstí 1b
603 00 Brno

Tel: +420 543 212 578

Email: info@ukralovnyelisky.cz

We will meet at the entrance of the restaurant at 19.30 p.m

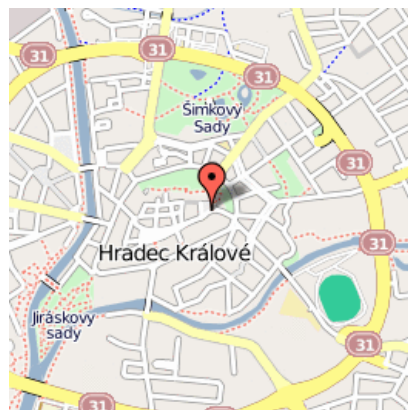

Wednesday, 6th June 2012

HALLWAY

Registration

09.00 - 09.30

09.00 – 10.00

ROOM B- 09.00-10.00

MANUF

SUPPLY CHAIN SIMULATION

Chair: Václav Simek, Brno Univ. of Technology, Brno, Czech Republic

TRANS_03

Supply Chain Replenishment Optimization under Uncertain Demand

S. T. Enns and Suvra Saha 141

TRANS_06_LOGIS

Logistic Chain Optimization for Importing Coal on Inland Waterways in Eastern India

T. van de Sande, J.A. Ottjes and G. Lodewijks 146

10.00 - 10.30

COFFEE BREAK

10.30 - 13.00

ROOM A- 10.30-13.00

ENGINE

SIMULATION IN ENGINEERING

Chair: Vladimír Janoušek, Brno Univ. of Technology, Brno, Czech Republic

ENGIN_01

Real Time 3D Simulation Tool for NC Sheet Metal Cutting and Punching Processes

Aitor Moreno, Alvaro Segura, Harbil Arregui, Alvaro Ruiz de Infante and Natxo Canto..... 55

ENGIN_05

WINTUS – A Simulator for Usual Wind Turbines

Dan Stefanoiu, Florin Sebastian Tudor and Janetta Culita 93

Wednesday, 6th June 2012

TOOLS_01

Cryogenic Helium Installation Simulation Model: Approaches to Implementation and Usage

Shpakov Vladimir..... 101

ENGIN_07

Improving the Performances of an Electro-Hydraulic Servo Valve by an Additional Position Feedback

Bogdan Mihalescu, Constantin Calinoiu, and Nicolae Vasiliu..... 105

ENGIN_03

Thermal Modeling of an Electric Motor used on Road Vehicle Powertrain

Valerian Croitorescu, Jan Anthonis and Nicolae Vasiliu 223

MEETING ROOM 13.00 - 13.15

BEST PAPER

CLOSING SESSION AND BEST PAPER AWARD

Chair: Vladimír Janoušek, Brno University of Technology, Brno, Czech Republic

ISC'2013

**SEE YOU ALL
MAY 22-24, 2013 FOR ISC'2013
GHENT UNIVERSITY, GHENT, BELGIUM**



**Track proposals and tutorial proposals can be sent in
by August 15th, 2012 to philippe.geril@eurosis.org**

Other ISC Conferences from 2013 onwards

ISC'2014, June 2014, Högskolan Skövde, Skövde, Sweden

ISC'2015, June 2015, [St.Petersburg State Institute of Technology](http://www.st-petersburg-state-institute-of-technology.ru/), St.Petersburg,
Russia

ISC'2016, June 2016, POLITEHNICA University of Bucharest, Bucharest, Romania

If you are interested in hosting an ISC conference, just contact EUROISIS.

ISC'2013 And Beyond

Conference Site Maps

Conference Site Maps

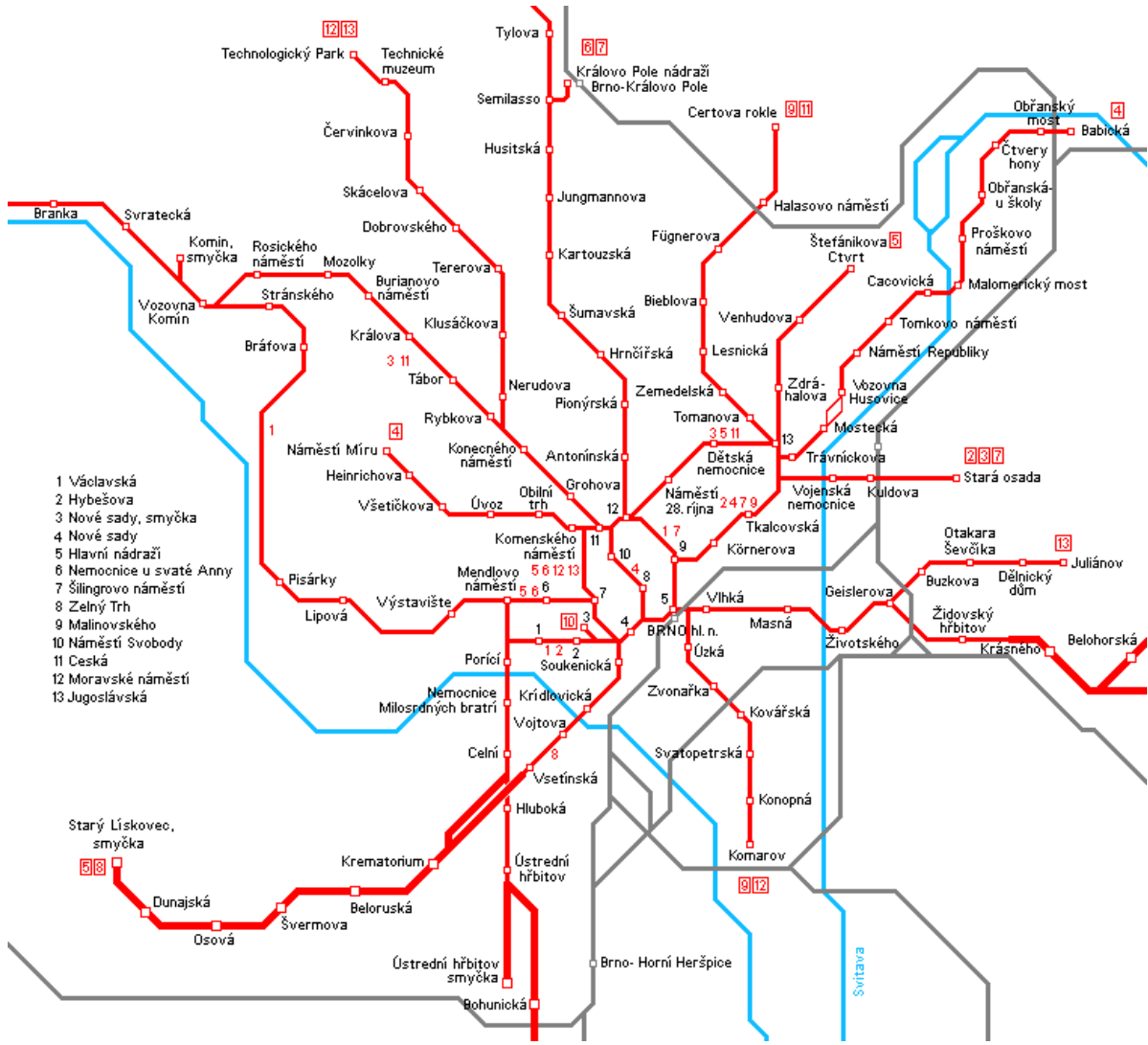

Metro Map of Brno

Conference Site Maps

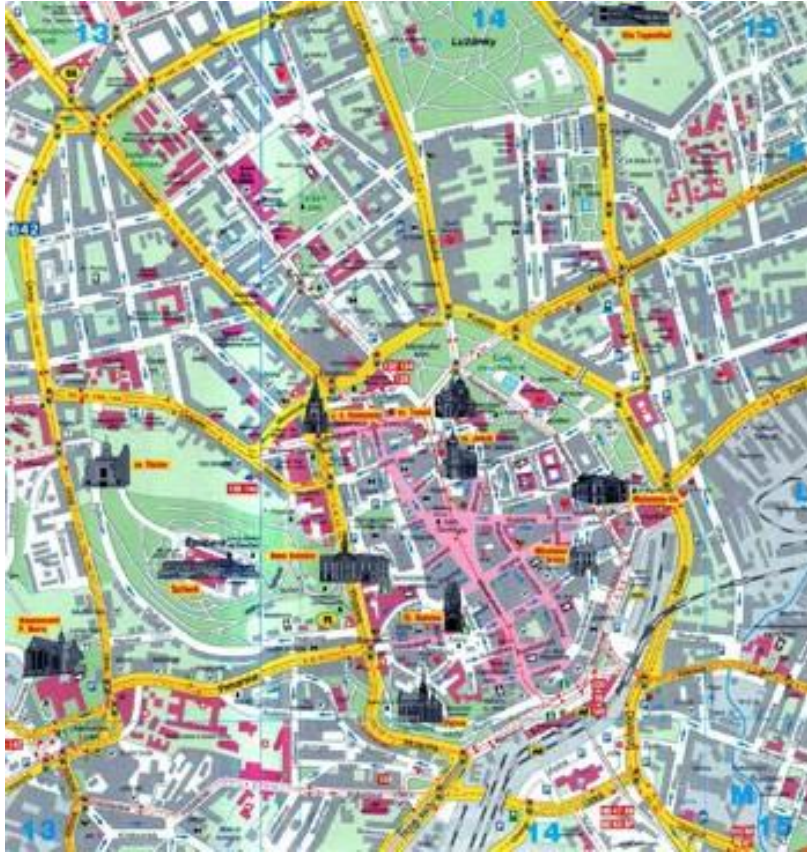

Hotel Map

On the map above Nadrazni" or "Hlavni nadrazi" is near the central train/tram station. Near from here is "grandhotel". Slovan is on Lidicka street.(3 stops from Hlavni nadrazi).

Conference Site Maps

Conference Site Maps

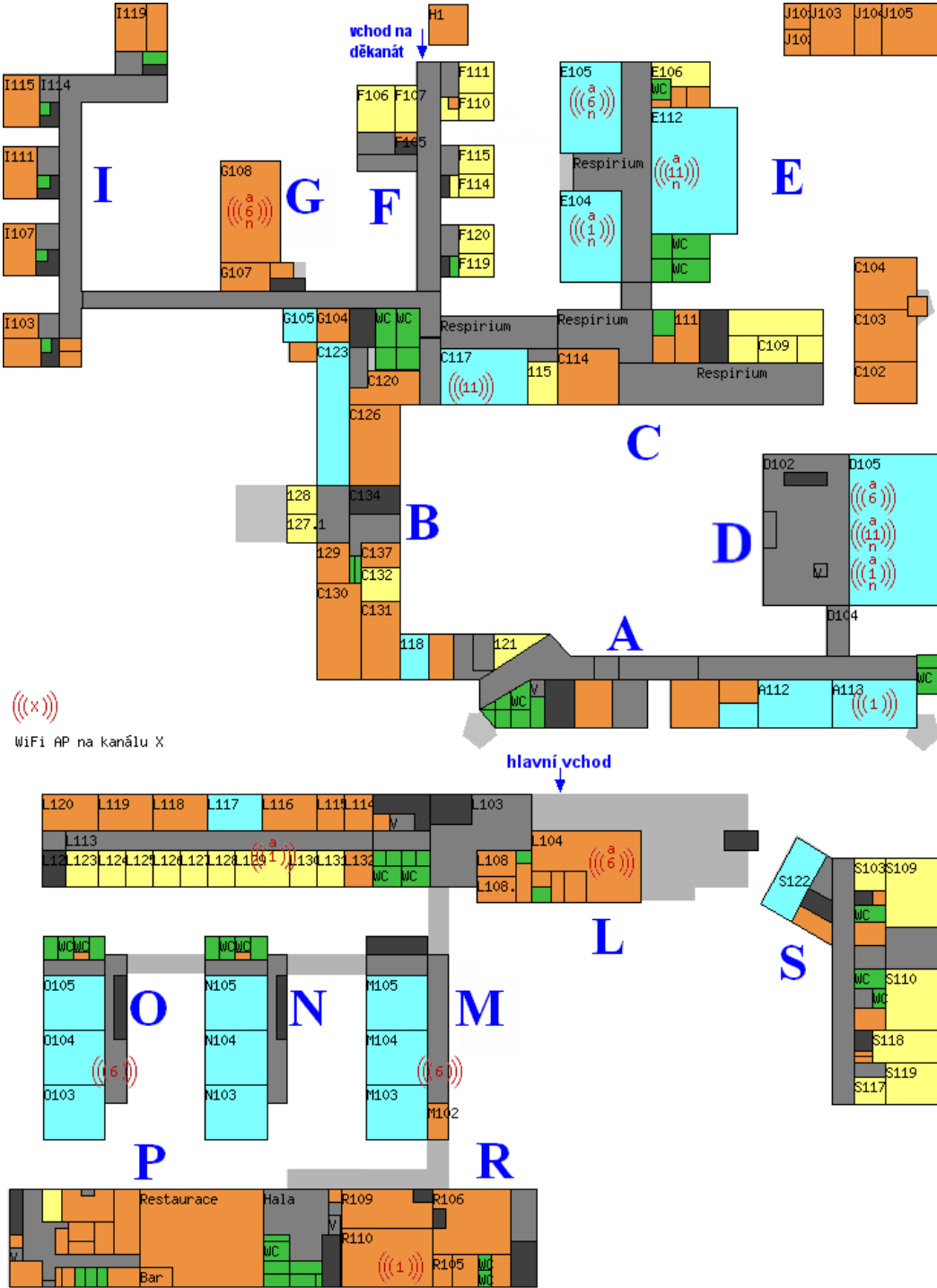

The meeting room will be A113 (see above: room in blue on the right in wing A)

NOTES

Conference Notes

ISC'2012 Registration Form

Please legibly print or type and fill out completely. (Check appropriate boxes where necessary)

FIRST NAME	LAST NAME	M.I.
COMPANY OR AFFILIATION		
Mailing address (tick one): <input type="checkbox"/> HOME <input type="checkbox"/> BUSINESS		
STREET		
CITY		
ZIPCODE	COUNTRY	
TELEPHONE	FAX	
E-MAIL		
DATE	SIGNATURE	
1. <input type="checkbox"/> EUROSIS member € 545 Member Number: _____		€ _____
2. <input type="checkbox"/> Members of Sponsor or Affiliate Society € 545		€ _____
3. <input type="checkbox"/> Non-Member Participant € 555		€ _____
4. <input type="checkbox"/> Students, <u>who are not authors</u> but who wish to attend the conference, or ONE DAY PARTICIPANTS pay: € 435		€ _____
(Above registration fees include, one copy of the PROCEEDINGS, all midday meals, cocktail, refreshments, coffees and social program,) One Day Participants and Non-Author Students cannot participate in the conference dinner.		
5. <input type="checkbox"/> Conference Dinner Ticket for Companion € 45 <input type="checkbox"/> Lunch Ticket for Companion € 25/day		€ _____
6. <input type="checkbox"/> Extra Conference Proceedings € 50 Cash and Carry		€ _____
VAT Number if applicable: _____		
TOTAL AMOUNT DUE		€ _____
ADD CZECH VAT OF 20% TO THE TOTAL (OBLIGATORY)		€ _____
ADD BANK CHARGE of € 15 in case you pay by BANK or CHEQUE.		€ _____
TOTAL AMOUNT REMITTED		€ _____

- [1] 1) Make payment by **BANK TRANSFER** to account **IBAN CODE: BE03 0014 0814 7784** EUROPEAN TECHNOLOGY INSTITUTE, ETI Bvba, BNP PARIBAS FORTIS BANK, Torhoutsesteenweg 356, B-8400 Ostend, Belgium, **SWIFT CODE: GEBABEBB MENTION YOUR NAME and ISC'2012**
- [1] 2) Or pay by **CHEQUE** and send it to Philippe Geril, EUROSIS-ETI, European Simulation Office, Greenbridge Science Park, Ghent University – Ostend Campus, Wetenschapspark 1, Plassendale 1, B-8400 Ostend, Belgium.
- [1] 3) Or pay by **CREDIT CARD** and fill in the information below:
 Charge my (tick one): Visa Euro/Mastercard American Express Diners
 CARD NO: _____ : _____ : _____ : _____ EXP.DATE: ____ / ____

Authorizing Signature:

Print Signature in CAPITALS

eurosis

EUROSIS was borne out of discussions with the European Community to set up a new kind of Society, which would be project driven instead of driven by pure membership and conferences.

The aim of EUROSIS is to set up topic related Technical Committees which will link directly to European Projects in the field of computer simulation and related areas and to act as a knowledge pool for future European Networks of Excellence, like MOSAIC.

If you would like to receive more information about EUROSIS, please contact

Philippe Geril
EUROSIS-ETI
European Simulation Office
Greenbridge Science Park
Ghent University – Campus Ostend
Wetenschapspark 1
Plassendale 1.
B- 8400 Ostend, Belgium
 Tel: +32.59.255.330
 Fax: +32.59.255.339
 **Email: Philippe.Geril@eurosis.org**

Please send me info on EUROSIS:

Name:

Address:

.....

.....

Telephone.....

Fax:

Email:

eurosis

The European Multidisciplinary Society for Modelling and Simulation

Application for Individual Membership

Full membership in EUROSIS is open to all who have been professionally involved in computer simulation and modelling and meet certain minimum requirements. **Associate membership** is available to anyone who is interested in the technology of simulation and modelling or in applications of the computer arts and sciences, individual membership in EUROSIS is individual not organizational and fully portable on the event of change in employment, Dues for senior, full and associate members are €50 per year. **Student membership** is open to any person regularly enrolled on a full-time basis in an institution of higher learning and the dues are €25 per year. Transfers of membership to another individual may only be done with the expressed written permission of the original holder of the membership. **Membership is valid from the date of payment for a period of 1 year.**

Please indicate only one Technical Committee area of your main interest

- | | | |
|---|--|--|
| <input type="checkbox"/> TC Aerospace | <input type="checkbox"/> Tools and Languages | <input type="checkbox"/> TC Multimedia |
| <input type="checkbox"/> TC Agent Based Simulation | <input type="checkbox"/> TC Discrete Event Methodology | <input type="checkbox"/> TC Operational Research |
| <input type="checkbox"/> TC AI Based Simulation | <input type="checkbox"/> TC Discrete Event Software Packages | <input type="checkbox"/> TC Parallel and Distributed Simulation |
| <input type="checkbox"/> TC Analytical and Numerical Modelling Techniques | <input type="checkbox"/> TC Discrete Event Tools and Languages | <input type="checkbox"/> TC Robotics |
| <input type="checkbox"/> TC Automotive Systems | <input type="checkbox"/> TC Electronics and Electrical Engineering | <input type="checkbox"/> TC Simulation Analysis |
| <input type="checkbox"/> TC Biology | <input type="checkbox"/> TC Engineering and Control | <input type="checkbox"/> TC Simulation and AI in Business Games |
| <input type="checkbox"/> TC Business and Economics Simulation | <input type="checkbox"/> TC Environmental Simulation | <input type="checkbox"/> TC Simulation and AI in Commercial Computer Games |
| <input type="checkbox"/> TC Chemical Engineering | <input type="checkbox"/> TC Food Simulation | <input type="checkbox"/> TC Simulation and Education |
| <input type="checkbox"/> TC Complex Systems | <input type="checkbox"/> TC High Performance Computing | <input type="checkbox"/> TC Socio-Economic Systems |
| <input type="checkbox"/> TC Computer Systems | <input type="checkbox"/> TC Industrial Design | <input type="checkbox"/> TC Sustainable Development |
| <input type="checkbox"/> TC Concurrent Engineering | <input type="checkbox"/> TC Logistics | <input type="checkbox"/> TC Telecommunications |
| <input type="checkbox"/> TC Continuous Event Simulation Methodology | <input type="checkbox"/> TC Manufacturing | <input type="checkbox"/> TC Textile Simulation |
| <input type="checkbox"/> TC Continuous Event Simulation Software Packages | <input type="checkbox"/> TC Medicine | <input type="checkbox"/> TC Traffic and Transport |
| <input type="checkbox"/> TC Continuous Event Simulation | <input type="checkbox"/> TC Military and Defence | <input type="checkbox"/> TC Verification, Validation and Accreditation |
| | <input type="checkbox"/> TC Multibody Systems | <input type="checkbox"/> TC Web Based Simulation |
| | | <input type="checkbox"/> Other_____ |

Please print or type

NAME _____ **INDIVIDUAL MEMBER** € 60

LAST FIRST M.I. _____ **ASSOCIATE MEMBER** € 60

COMPANY OR AFFILIATION _____ **STUDENT MEMBER** € 25
(include a copy of your student ID Card to validate)

Mailing address (tick one):

HOME BUSINESS

STREET _____

CITY _____

ZIPCODE COUNTRY _____

() / ()
TELEPHONE FAX _____

EMAIL _____

DATE SIGNATURE _____

1) Make payment by **BANK TRANSFER** to account **No. 001-5842218-81**, Swift Code: **GEBABEBB: 001-5842218-81** IBAN CODE: **BE36 0015 8422 1881**, Account Holder: EUROSIS Vzw. BNP Paribas Fortis Bank, Torhoutsesteenweg 195, B-8400 Ostend, Belgium, **MENTION YOUR NAME AND ADD A COPY OF PAYMENT TO THIS FORM. Make sure the correct amount is deposited otherwise add €15 bank costs.**

2) Or pay by **CHEQUE** and send it to Philippe Geril, c/o EUROSIS-ETI, Greenbridge NV, Wetenschapspark 1, Plassendale 1, B-8400 Ostend, Belgium. **Make sure the correct amount is deposited otherwise add €15 bank costs.**

3) Or pay by **CREDITCARD**: (amount deducted in € only):
Charge my (tick one)

Visa Mastercard American Express Diners

||| ||| ||| ||| |||
CARD NO. EXP. DATE

Authorizing Signature

PRINT SIGNATURE if you are NOT the Owner of the Card

Send Membership Application to:
EUROSIS, European Simulation Office, Greenbridge NV, Wetenschapspark 1, B-8400 Ostend, Belgium
Tel: +32.59.255.330 Fax: +32.59.255.339 email: Philippe.Geril@eurosis.org